



KelairPumps

CALL 1300 789 466

ANSIMAG K-Plus

WHEN PUMP
KNOWLEDGE
MATTERS

The most reliable sealless process pump for keeping your plant up and running.



The Ansimag K-Plus is an ANSI/ASME compliant, sealless, non-metallic, magnet drive centrifugal pump. No leaks by design.

This standard pump covers a wide range of sizes and includes standard external dimensions allowing for interchangeability with other brands and manufacturers.

Also available in a low system temperature configuration, the K Plus is ideal for most corrosive or acidic applications in the chemical, power and industrial, hydrocarbon and oil and gas industries.



SPECIFICATIONS

- Flows: To 125m³/hr
- Head: 67m
- Temperature: -3°C to - 120°C
- Viscosity: to 150,000 cps

KELAIR PUMPS AUSTRALIA - 1300 789 466

When Pump Knowledge Matters



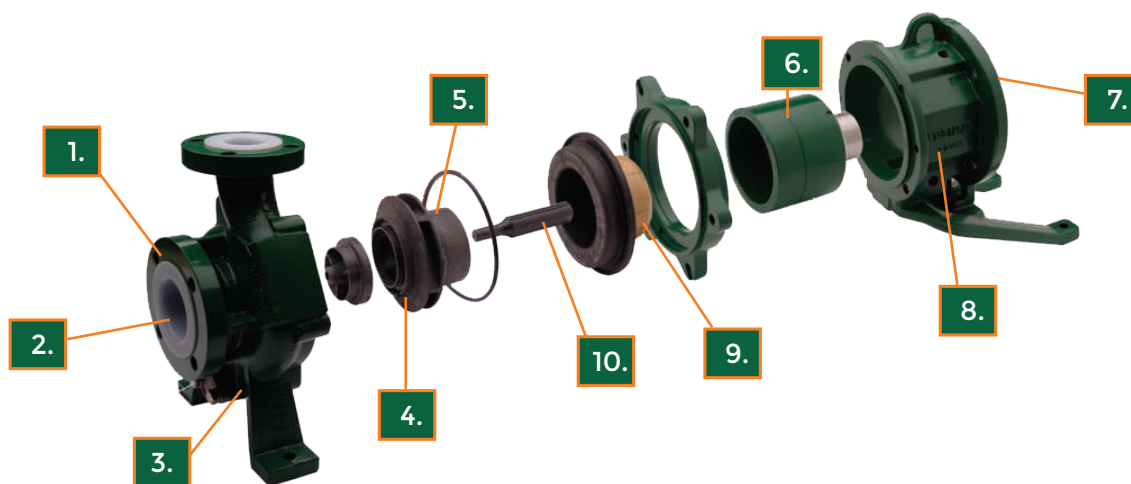

- 1. Durable Construction**
Ductile iron exterior is designed for heavy-duty chemical applications.
- 2. Chemically Resistant Lining**
Carbon Fiber reinforced ETFE is chemically resistant to most chemicals.
- 3. Zero Leakage**
ANSIMAG pumps feature a single, fully confined, O-ring to eliminate possible leakage.
- 4. Replaceable Impeller**
Single piece closed impeller can be easily changed out if process conditions change.
- 5. Fully Encapsulated Drive**
Full encapsulated inner drive provides unsurpassed resistance to chemical attack.
- 6. Magnetic Drive**
Neodymium Iron Boron magnets provide a powerful, permanent magnetic coupling.
- 7. Close Coupled**
With a small footprint, quiet operation and low maintenance, the pump features standard, off the shelf flange motors.
- 8. Corrosion Protection**
Powder Coat exterior is more durable and chemically resistant than Epoxy based paints.
- 9. Sealless Containment**
Lined Kevlar Fiber/Epoxy construction provides unsurpassed pressure handling capability.
- 10. Radial Thrust**
Fully supported shaft eliminates deflection for maximum durability.

APPLICATIONS

- Corrosive and Toxic Services
- Chemical Processing and Transfer
- Water Supply, Pollution and Wastewater
- Produce Water Transfer
- Brine Injection and Disposal
- Agrochemicals
- Reactor Feed
- Industrial Waste
- Coatings and Plastics
- Mineral Processing
- Metal Pickling and Plating
- Cargo Loading and Unloading
- Battery Manufacturing

MATERIALS

- Carbon Fiber Reinforced ETFE
- Glass Fiber Reinforced PFA (impeller parts)
- ETFE or PFA lined ductile iron (casing)

WHY ANSIMAG?

- Leading supplier of ETFE-lined Process Pumps to industry since 1985
- Cost efficient with non metallic and simple, low maintenance designs
- Application experts
- Quality products meeting ISO 9001: 2008 internationally recognised Quality Management System standards

We know the importance of choosing the right equipment to match your process. Whatever your pump requirements, we will help you achieve the best pumping solution.

When Pump Knowledge Matters