

<p>Order Code</p> <table style="width:100%; border-collapse: collapse;"> <tr> <td style="width:15%;">Base Code</td> <td style="width:15%; text-align: center;">Gear Set</td> <td style="width:15%;"></td> <td style="width:15%; text-align: center;">Drive Mount</td> <td style="width:15%;"></td> <td style="width:15%;">Options</td> </tr> <tr> <td style="border: 1px solid black; text-align: center;">G</td> <td style="border: 1px solid black; text-align: center;">D</td> <td style="border: 1px solid black; text-align: center;">-</td> <td style="border: 1px solid black; text-align: center;">M35</td> <td style="border: 1px solid black; text-align: center;">5</td> <td style="border: 1px solid black;"></td> </tr> <tr> <td style="text-align: center;">1</td> <td style="text-align: center;">2</td> <td style="text-align: center;">3</td> <td style="text-align: center;">4</td> <td style="text-align: center;">5</td> <td style="text-align: center;">6</td> </tr> <tr> <td colspan="3" style="text-align: center;">Model</td> <td colspan="3" style="text-align: center;">Wetted Materials</td> </tr> </table> <p style="margin-top: 5px;">O/C: Pump S/K: Service Kit</p>	Base Code	Gear Set		Drive Mount		Options	G	D	-	M35	5		1	2	3	4	5	6	Model			Wetted Materials			<p>Pump Construction</p> <p>Magnetic Drive Gear Pump Cavity Style Three Helical Gears/DP20 Stationary Shafts O-Ring Seal (Qty 1)</p>
Base Code	Gear Set		Drive Mount		Options																				
G	D	-	M35	5																					
1	2	3	4	5	6																				
Model			Wetted Materials																						

Product Options

Base Code Select a code character for each numbered position to configure the product.

1	Code	Product Type	Specifications	Notes
	G	Gear Pump		
2	D	Series GD	Max System Pressure (MAWP) See Drive Mount	Ports 3/8-18 (F) NPT Side Ports
3	-	Standard Design		
4	M35	Gear Set (Width/N°Gears/Pitch)	Displacement 3.48 ml/rev (0.92 gal/1000*rev)	Max Differential Pressure 6.9 Bar (100 psi) Driven Magnet (Standard) Ferrite
5	2	Gear Material		Max Differential Pressure Temp Range
	J	PEEK (carbon fiber/ptfe)		5.2 Bar (75 psi) -46/260°C (-50/500°F)
	P	PPS (carbon fiber/ptfe)		8.7 Bar (125 psi) -46/121°C (-50/250°F)
				5.2 Bar (75 psi) -46/121°C (-50/250°F)
6	V	Static Seals		Temp Range
	D	Viton®		-29/204°C (-20/400°F)
	K	EP		-46/149°C (-50/300°F)
	F5	Kalrez®		-29/260°C (-20/500°F)
		TEV (PTFE encap Viton®)		-29/204°C (-20/400°F)
7	C	Base Materials		
	D	Hast C-276®		
	S	Alloy 20		
	T	SS316		
		Titanium		
8	E	Drive Mount	Max System Pressure (MAWP)	Weight (Pumphead)
	4	NEMA 56C	103 Bar (1500 psi)	2.7 kg (6.0 lbs)
	6	IEC 63-B14	103 Bar (1500 psi)	2.7 kg (6.0 lbs)
		IEC 71-B14	103 Bar (1500 psi)	2.7 kg (6.0 lbs)

Options Add Option codes after the Base Code to modify features or enhance the product.

Driving Magnet (PC13)
N3 NdFeB Driving (Ring)

Notes
1 price adder for service kit includes cavity plate
2 Available only with Hybrid/Abrasive Modifier PC3 R

ACTUAL PERFORMANCE MAY VARY - Specifications are subject to change without notice. When multiple specs are noted, the most conservative value applies.

USA: Micropump, Inc., A Unit of IDEX Corporation • Phone 360.253.2008 • Fax 360.253.2401
UK: Micropump, Ltd., A Subsidiary of Micropump, Inc. • Phone +44 (1480) 356900 • Fax +44 (1480) 356920
info@micropump.com www.micropump.com



Technical Data

Series GD

Order Code				Options			
Base Code		Gear Set		Drive Mount			
G	D	-	M35				
1	2	3	4	5	6	7	8
Model			Wetted Materials				
				O/C: Pump S/K: Service Kit			

Pump Construction
 Magnetic Drive Gear Pump
 Cavity Style
 Three Helical Gears/DP20
 Stationary Shafts
 O-Ring Seal (Qty 1)



Performance

GD-M35

Water @ 1 CP

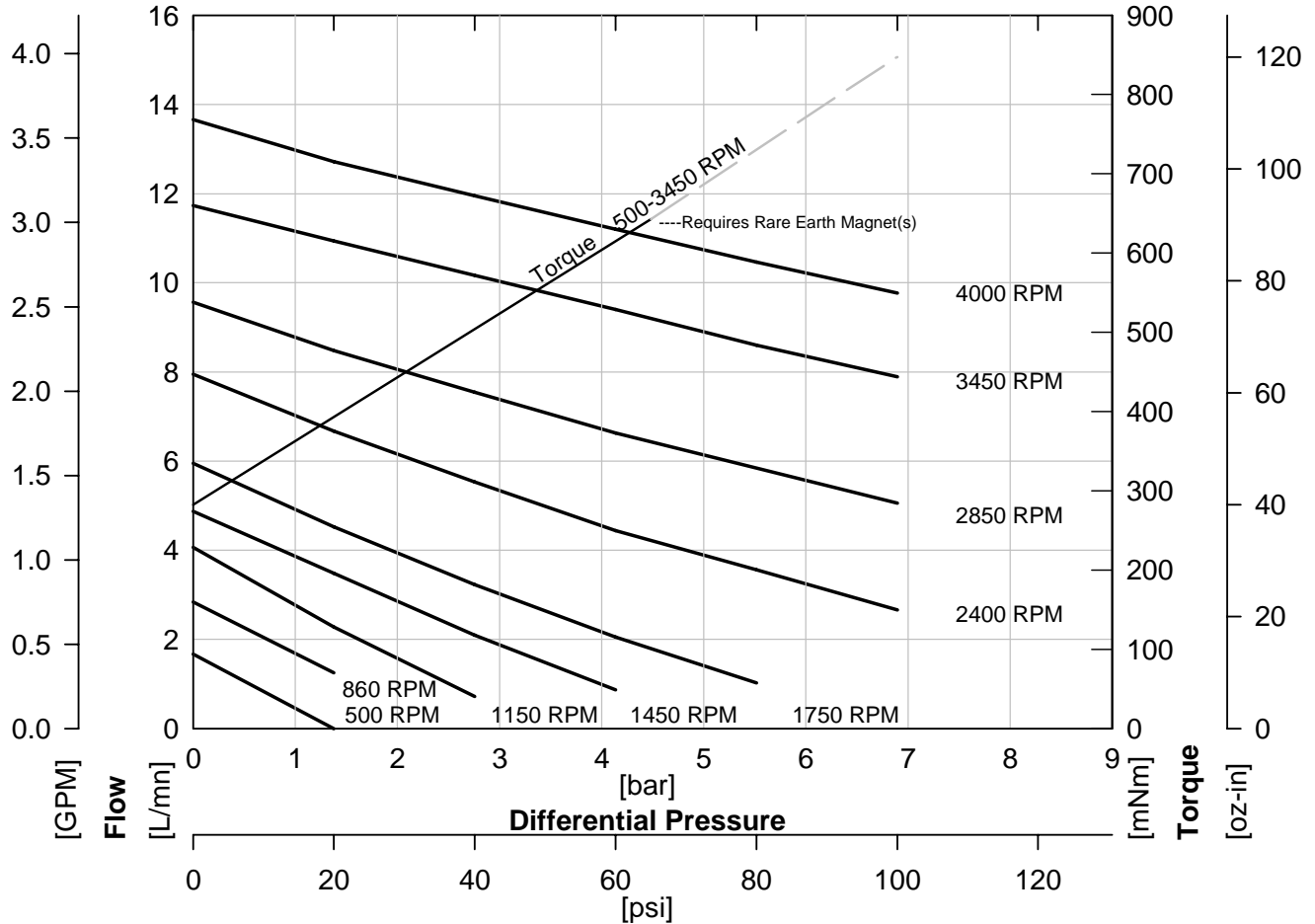

ACTUAL PERFORMANCE MAY VARY - Specifications are subject to change without notice. When multiple specs are noted, the most conservative value applies.

USA: Micropump, Inc., A Unit of IDEX Corporation • Phone 360.253.2008 • Fax 360.253.2401
 UK: Micropump, Ltd., A Subsidiary of Micropump, Inc. • Phone +44 (1480) 356900 • Fax +44 (1480) 356920
 info@micropump.com www.micropump.com

Order Code				Pump Construction			
Base Code		Gear Set		Drive Mount		Options	
G	D	-	M35	4	6	4/6	
1	2	3	4	5	6	7	8
Model				Wetted Materials			
				O/C: Pump S/K: Service Kit			
				Magnetic Drive Gear Pump Cavity Style Three Helical Gears/DP20 Stationary Shafts O-Ring Seal (Qty 1)			



Dimensions

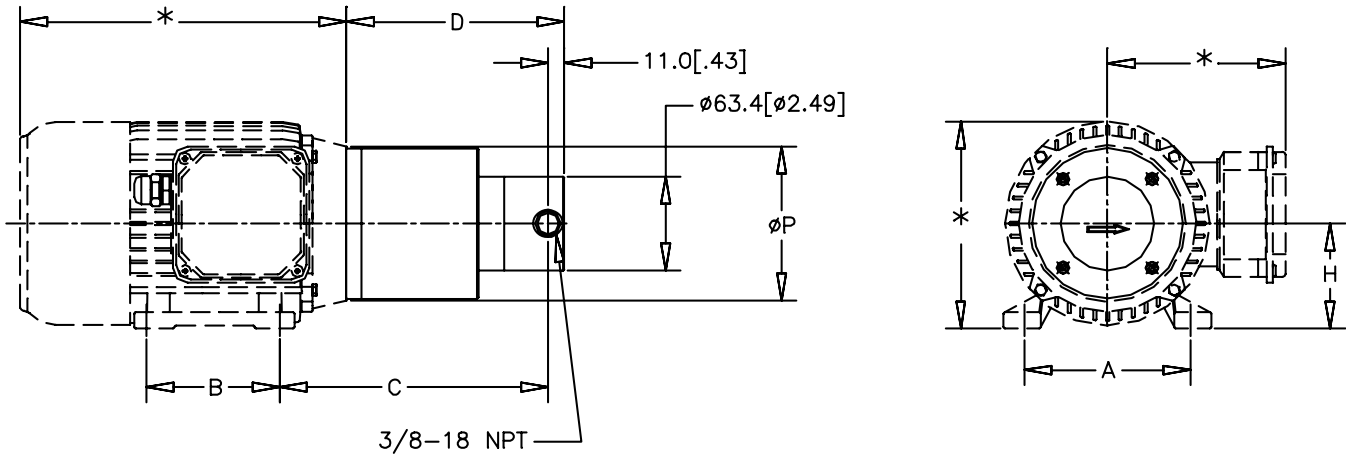

PUMP	MOUNT	A mm [in]	B mm [in]	C mm [in]	D mm [in]	H mm [in]	P mm [in]
GD-M35	4 IEC63B14B3	100 [3.94]	80 [3.15]	168.9 [6.65]	139.9 [5.51]	63 [2.48]	90 [3.54]
	6 IEC71B14B3	112 [4.41]	90 [3.54]	180.9 [7.12]	139.9 [5.51]	71 [2.80]	105 [4.13]

NOTES:

1. *THESE DIMENSIONS WILL VARY BASED ON MOTOR SELECTION.
2. ALL DIMENSIONS ARE NOMINAL.

ACTUAL PERFORMANCE MAY VARY - Specifications are subject to change without notice. When multiple specs are noted, the most conservative value applies.

USA: Micropump, Inc., A Unit of IDEX Corporation • Phone 360.253.2008 • Fax 360.253.2401
 UK: Micropump, Ltd., A Subsidiary of Micropump, Inc. • Phone +44 (1480) 356900 • Fax +44 (1480) 356920
 info@micropump.com www.micropump.com

Order Code				Pump Construction			
Base Code		Gear Set		Drive Mount		Options	
G	D	-	M35			E	
Model			Wetted Materials			O/C: Pump S/K: Service Kit	
				Magnetic Drive Gear Pump Cavity Style Three Helical Gears/DP20 Stationary Shafts O-Ring Seal (Qty 1)			



Dimensions

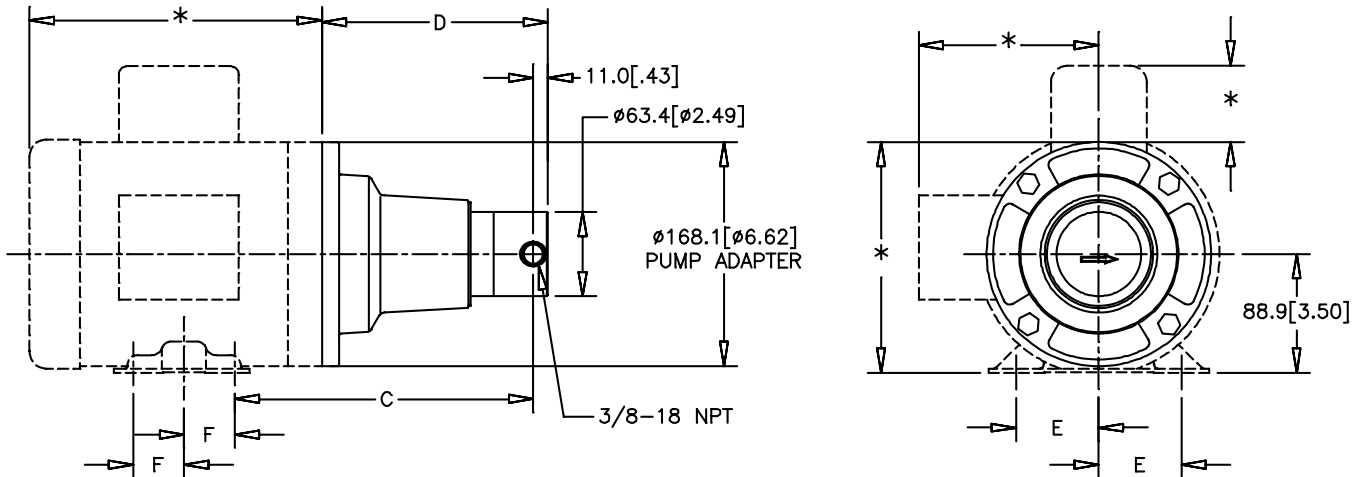

PUMP	MOUNT	C mm [in]	D mm [in]	E mm [in]	F mm [in]
GC-M23	E NEMA 56C	206.4 [8.13]	152.1 [5.99]	61.9 [2.44]	38.1 [1.50]
	K	201.5 [7.94]	152.1 [5.99]	69.9 [2.75]	50.8 [2.00]
	K NEMA 145TC	201.5 [7.94]	152.1 [5.99]	69.9 [2.75]	63.5 [2.50]
GC-M25/M35 GD-M35	E NEMA 56C	223.5 [8.80]	169.2 [6.66]	61.9 [2.44]	38.1 [1.50]
	K NEMA 143TC	218.7 [8.61]	169.2 [6.66]	69.9 [2.75]	50.8 [2.00]
	K NEMA 145TC	218.7 [8.61]	169.2 [6.66]	69.9 [2.75]	63.5 [2.50]

NOTES:

- *THESE DIMENSIONS WILL VARY BASED ON MOTOR SELECTION.
- ALL DIMENSIONS ARE NOMINAL.

AUSTRALIAN DISTRIBUTOR



CALL 1300 789 466
 When Pump Knowledge Matters
www.kelairpumps.com.au

ACTUAL PERFORMANCE MAY VARY - Specifications are subject to change without notice. When multiple specs are noted, the most conservative value applies.

USA: Micropump, Inc., A Unit of IDEX Corporation • Phone 360.253.2008 • Fax 360.253.2401
 UK: Micropump, Ltd., A Subsidiary of Micropump, Inc. • Phone +44 (1480) 356900 • Fax +44 (1480) 356920
info@micropump.com www.micropump.com