

Technical Specification Data

| | | | | | | | | | | | | | | | | | | | | | | | | | |
|--|----|----|---|------------------|---|-------------------------------|---|--|---|---|---|---|---|---|---|---|-------|--|--|--|------------------|--|-------------------------------|--|---|
| <p>Order Code</p> <p>Base Code Gear Set Drive Mount</p> <table border="1" style="width: 100%; text-align: center;"> <tr> <td style="width: 12.5%;">G</td> <td style="width: 12.5%;">JR</td> <td style="width: 12.5%;"></td> <td style="width: 12.5%;"></td> <td style="width: 12.5%;"></td> <td style="width: 12.5%;"></td> <td style="width: 12.5%;"></td> <td style="width: 12.5%;"></td> </tr> <tr> <td>1</td> <td>2</td> <td>3</td> <td>4</td> <td>5</td> <td>6</td> <td>7</td> <td>8</td> </tr> <tr> <td colspan="4">Model</td> <td colspan="2">Wetted Materials</td> <td colspan="2">O/C: Pump S/K: Service Kit</td> </tr> </table> | G | JR | | | | | | | 1 | 2 | 3 | 4 | 5 | 6 | 7 | 8 | Model | | | | Wetted Materials | | O/C: Pump S/K: Service Kit | | <p>Pump Construction</p> <p>Magnetic Drive Gear Pump Cavity Style Two Spur, Shafted Gears Sleeve Bushings/Gasket Seals (2) PTFE Bevel or O-Ring Seal (1)</p> |
| G | JR | | | | | | | | | | | | | | | | | | | | | | | | |
| 1 | 2 | 3 | 4 | 5 | 6 | 7 | 8 | | | | | | | | | | | | | | | | | | |
| Model | | | | Wetted Materials | | O/C: Pump S/K: Service Kit | | | | | | | | | | | | | | | | | | | |

Base Code Select a code character for each numbered position to configure the product.

| Code | Product Type | Specifications | Notes |
|------|----------------------------------|----------------------------------|---|
| 1 | G Gear Pump | | |
| 2 | Product Series | Max System Pressure (MAWP) | Ports |
| | JR Series GJR | 21 Bar (300 psi) | 1/8-28 B.S.P.P. Side Ports |
| 3 | Modifier | | |
| | - Standard Design | | |
| 4 | Gear Set (Width/N°Gears/Pitch) | Displacement | Max Differential Pressure Driven Magnet (Standard) |
| | N21 0.175 / 2 / 24 | 0.316 ml/rev (0.08 gal/1000*rev) | 5.5 Bar (80 psi) Ferrite |
| | N23 0.350 / 2 / 24 | 0.64 ml/rev (0.17 gal/1000*rev) | 5.5 Bar (80 psi) Ferrite |
| | N27 0.700 / 2 / 24 | 1.23 ml/rev (0.32 gal/1000*rev) | 5.5 Bar (80 psi) Ferrite |
| 5 | Gear Material | | Max Differential Pressure Temp Range |
| | 99 Solid Nickel Carbide | | 5.5 Bar (80 psi) -46/121°C (-50/250°F) |
| 6 | Static Seals | | Temp Range |
| | F1 PTFE Gasket (.004) 5369 | | -46/121°C (-50/250°F) |
| | F4 PTFE Gasket (.004) 5369 | | -46/121°C (-50/250°F) |
| | F11 PTFE Gaskets/ Viton O-Ring | | -46/121°C (-50/250°F) 1 |
| | F12 PTFE Gaskets/ EP O-Ring | | -46/121°C (-50/250°F) 1 |
| | F15 PTFE Gasket/ TEV O-Ring | | -46/121°C (-50/250°F) 1 |
| 7 | Base Materials | | |
| | S SS316 | | |
| 8 | Drive Mount | Max System Pressure (MAWP) | Weight (Pumphead) |
| | A* MP Housing | 21 Bar (300 psi) | 0.34 kg (0.75 lbs) |
| | SE EagleDrive™ MS | 21 Bar (300 psi) SS316 | 0.45 kg (1.0 lbs) |
| | LE EagleDrive™ EL | 21 Bar (300 psi) SS316 | 0.45 kg (1.0 lbs) |

*A-mount housing can be adapted to any NEMA 56C or IEC motor

Technical Specification Data

| Order Code | | | | | | | | Pump Construction | |
|------------|----|----------|------------------|---|---|---|---|----------------------------------|--|
| Base Code | | Gear Set | | | | | | Drive Mount | |
| G | JR | | | | | | | | |
| 1 | 2 | 3 | 4 | 5 | 6 | 7 | 8 | O/C: Pump S/K: Service Kit | |
| Model | | | Wetted Materials | | | | | | |
| | | | | | | | | Magnetic Drive Gear Pump | |
| | | | | | | | | Cavity Style | |
| | | | | | | | | Two Spur, Shafted Gears | |
| | | | | | | | | Sleeve Bushings/Gasket Seals (2) | |
| | | | | | | | | PTFE Bevel or O-Ring Seal (1) | |

Options Add Option codes after the Base Code to modify features or enhance the product.

Bypass C11

Optional System Bypass

Notes

Driven Magnet (PC12)

Driving Magnet (PC13)

N3 NdFEB Driving (Ring)

2

Ports / Fittings (PC17)

Ports

P2 1/8-28 B.S.P.P. Ports

1/8-28 B.S.P.P. Ports

Ports Orientation (PC18)

Ports

Q1 Deck Ports

Deck Ports

1

Notes

1 - Denotes customization or materials that may require minimum order quantities.

2- Available only with industrial IEC or NEMA drive mounts

Technical Specification Data

| Order Code | | | | | | | | Pump Construction | | |
|------------|----|----------|------------------|-------------|---|---|-------------------------------|-------------------------------|----------------------------------|--|
| Base Code | | Gear Set | | Drive Mount | | | | Magnetic Drive Gear Pump | | |
| G | JR | - | N21 | | | | | Cavity Style | | |
| 1 | 2 | 3 | 4 | 5 | 6 | 7 | 8 | Two Spur, Shafted Gears | | |
| Model | | | Wetted Materials | | | | O/C: Pump S/K: Service Kit | | Sleeve Bushings/Gasket Seals (2) | |
| | | | | | | | | PTFE Bevel or O-Ring Seal (1) | | |

Performance

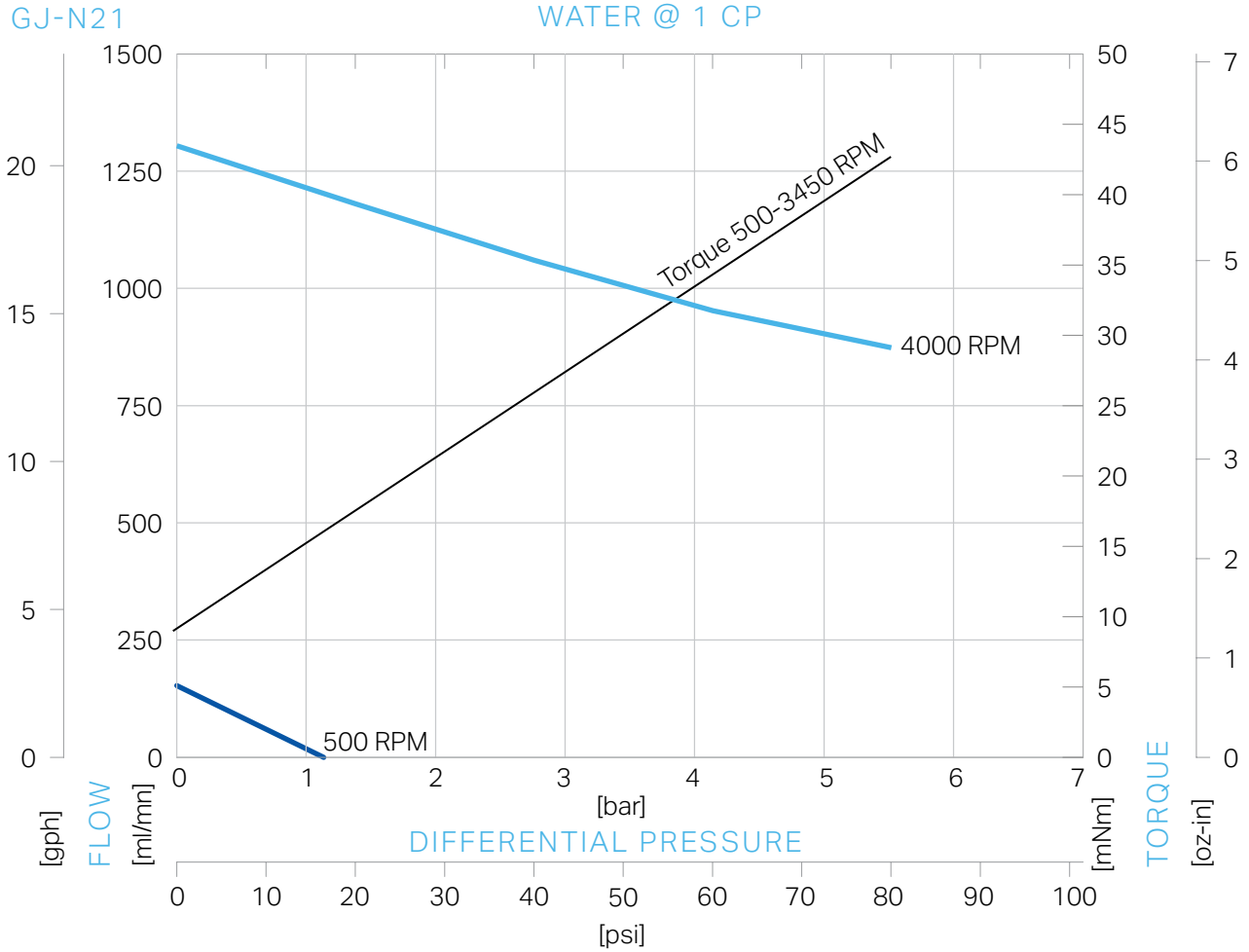

ACTUAL PERFORMANCE MAY VARY - Specifications are subject to change without notice. When multiple specs are noted, the most conservative value applies.

Technical Specification Data

| | | | | | | | | | |
|-------------------|----|----------|------------------|-------------|---|---|-----------|-------------------------------|----------------------------------|
| Order Code | | | | | | | | Pump Construction | |
| Base Code | | Gear Set | | Drive Mount | | | | Magnetic Drive Gear Pump | |
| G | JR | - | N21 | | | | | Cavity Style | |
| 1 | 2 | 3 | 4 | 5 | 6 | 7 | 8 | Two Spur, Shafted Gears | |
| Model | | | Wetted Materials | | | | O/C: Pump | | Sleeve Bushings/Gasket Seals (2) |
| | | | | | | | | PTFE Bevel or O-Ring Seal (1) | |
| | | | | | | | | S/K: Service Kit | |

Performance-High Viscosity

GJ-N21

OIL @ 100 CP

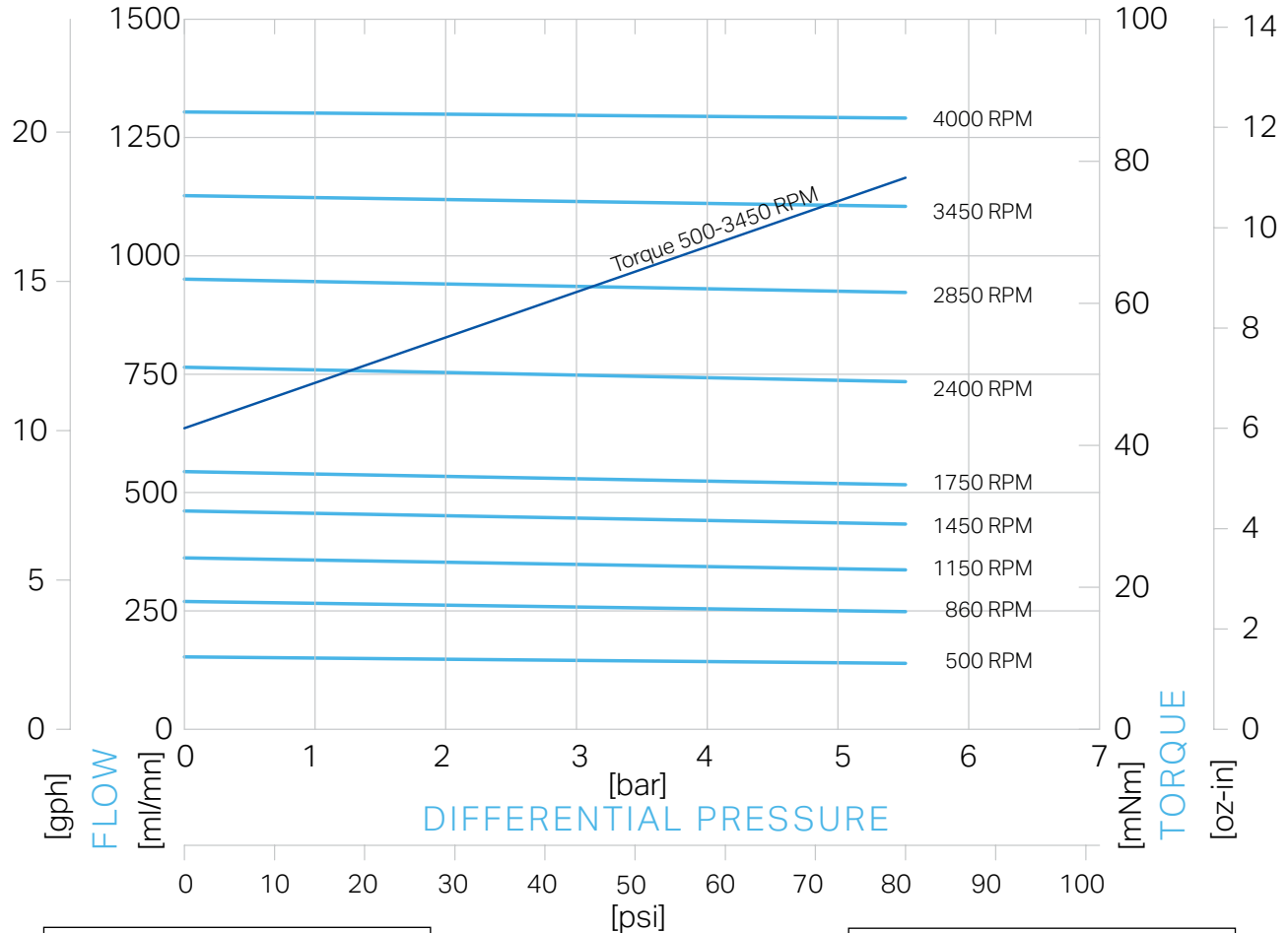

$$\text{Watts} = \frac{\text{Torque [mNm]} \times \text{Speed [RPM]}}{9555}$$

$$\text{Watts} = \frac{\text{Torque [oz-in]} \times \text{Speed [RPM]}}{1.008 \times 10^6}$$

To calculate torque, multiply correction factor by torque from viscosity curve above.

| Torque Correction Factors: For Higher Viscosity Liquids | | | | |
|---|-------|--------|------|------|
| Viscosity [cp] | | 1 | 100 | 1500 |
| Max Speed [RPM] | | 10,000 | 3450 | 860 |
| [Bar] | [psi] | | | |
| 0.3 | 5 | 0.2 | 1 | 2.3 |
| 1.4 | 20 | 0.3 | 1 | 2.1 |
| 2.8 | 40 | 0.4 | 1 | 1.9 |
| 4.1 | 60 | 0.5 | 1 | 1.8 |
| 5.5 | 80 | 0.5 | 1 | 1.6 |

| Magnet Decouple Torque | | | |
|------------------------|-------------|--------------|------------------|
| Driven Magnet | Driving Hub | Torque [mNm] | Torque [oz. in.] |
| Ferrite | Ferrite | 113 | 16 |
| Ferrite | Ferrite | 134 | 19 |
| Ferrite | SmCo | 254 | 36 |
| SmCo | SmCo | 636 | 90 |
| Ferrite | NdFeB | 304 | 43 |
| SmCo | NdFeB | 932 | 132 |

ACTUAL PERFORMANCE MAY VARY - Specifications are subject to change without notice. When multiple specs are noted, the most conservative value applies.

Technical Specification Data

| Order Code | Pump Construction | | | | | | | | | | | | | | | | | | | | | | | | | | | |
|--|-------------------|----|------------------|-----|---|-------------|---|--|--|---|---|---|---|---|---|---|---|--|-------|--|--|------------------|--|--|-------------|--|--|---|
| <p>Base Code</p> <table border="1"> <tr> <td>G</td> <td>JR</td> <td>-</td> <td>N21</td> <td></td> <td></td> <td></td> <td></td> <td></td> </tr> <tr> <td>1</td> <td>2</td> <td>3</td> <td>4</td> <td>5</td> <td>6</td> <td>7</td> <td>8</td> <td></td> </tr> <tr> <td colspan="3">Model</td> <td colspan="3">Wetted Materials</td> <td colspan="2">Drive Mount</td> <td></td> </tr> </table> <p>O/C: Pump S/K: Service Kit</p> | G | JR | - | N21 | | | | | | 1 | 2 | 3 | 4 | 5 | 6 | 7 | 8 | | Model | | | Wetted Materials | | | Drive Mount | | | <p>Magnetic Drive Gear Pump</p> <p>Cavity Style</p> <p>Two Spur, Shafted Gears</p> <p>Sleeve Bushings/Gasket Seals (2)</p> <p>PTFE Bevel or O-Ring Seal (1)</p> |
| G | JR | - | N21 | | | | | | | | | | | | | | | | | | | | | | | | | |
| 1 | 2 | 3 | 4 | 5 | 6 | 7 | 8 | | | | | | | | | | | | | | | | | | | | | |
| Model | | | Wetted Materials | | | Drive Mount | | | | | | | | | | | | | | | | | | | | | | |

Specifications

| | SI | US |
|-------------------------------|----------------------------|----------------------------|
| Displacement | 0.316 ml/rev | 0.08 gal/1000*rev |
| Max Flow (4 Pole Speed) | 460 ml/mn 1450 RPM (50Hz) | 8.9 gal/hr 1750 RPM (60Hz) |
| Max Flow (2 Pole Speed) | 910 ml/mn 2850 RPM (50Hz) | 18 gal/hr 3450 RPM (60Hz) |
| Max Differential Pressure | 1 5.5 Bar | 80 psi |
| Max System Pressure (MAWP) | 21 Bar | 300 psi |
| NIPR (Absolute) | 180 mBar | 2.5 psia |
| Wet Lift (Typical) | 2 51 cm.H2O (1450 RPM) | 24 in.H2O (1750 RPM) |
| Temp Range | 3 See Gear Material | See Gear Material |
| Viscosity Range | 4 0.2 to 1500 cp | 0.2 to 1500 cp |
| Max Speed | 5,500 RPM | 5,500 RPM |
| Rotation (Facing Motor Shelf) | CW | CW |
| Weight (Pumphead) | 0.45 kg | 1.0 lbs |
| Dimensions (LxWxH) | See Drawing | See Drawing |
| Ports | 1/8-28 B.S.P.P. Side Ports | 1/8-28 B.S.P.P. Side Ports |
| Driven Magnet (Standard) | Ferrite | Ferrite |

Notes

- 1 - See Product Options. Max pressure depends on gear material.
- 2 - Priming ability varies with operating conditions.
- 3 - See Product Options for specific temp limits.
- 4 - See Performance-High Viscosity for viscosity limits.

Technical Specification Data

| Order Code | | | | | | | | Pump Construction | |
|------------|----|----------|------------------|-------------|---|-------------------------------|---|----------------------------------|--|
| Base Code | | Gear Set | | Drive Mount | | | | Magnetic Drive Gear Pump | |
| G | JR | - | N23 | | | | | Cavity Style | |
| 1 | 2 | 3 | 4 | 5 | 6 | 7 | 8 | Two Spur, Shafted Gears | |
| Model | | | Wetted Materials | | | O/C: Pump S/K: Service Kit | | Sleeve Bushings/Gasket Seals (2) | |
| | | | | | | | | PTFE Bevel or O-Ring Seal (1) | |

Performance

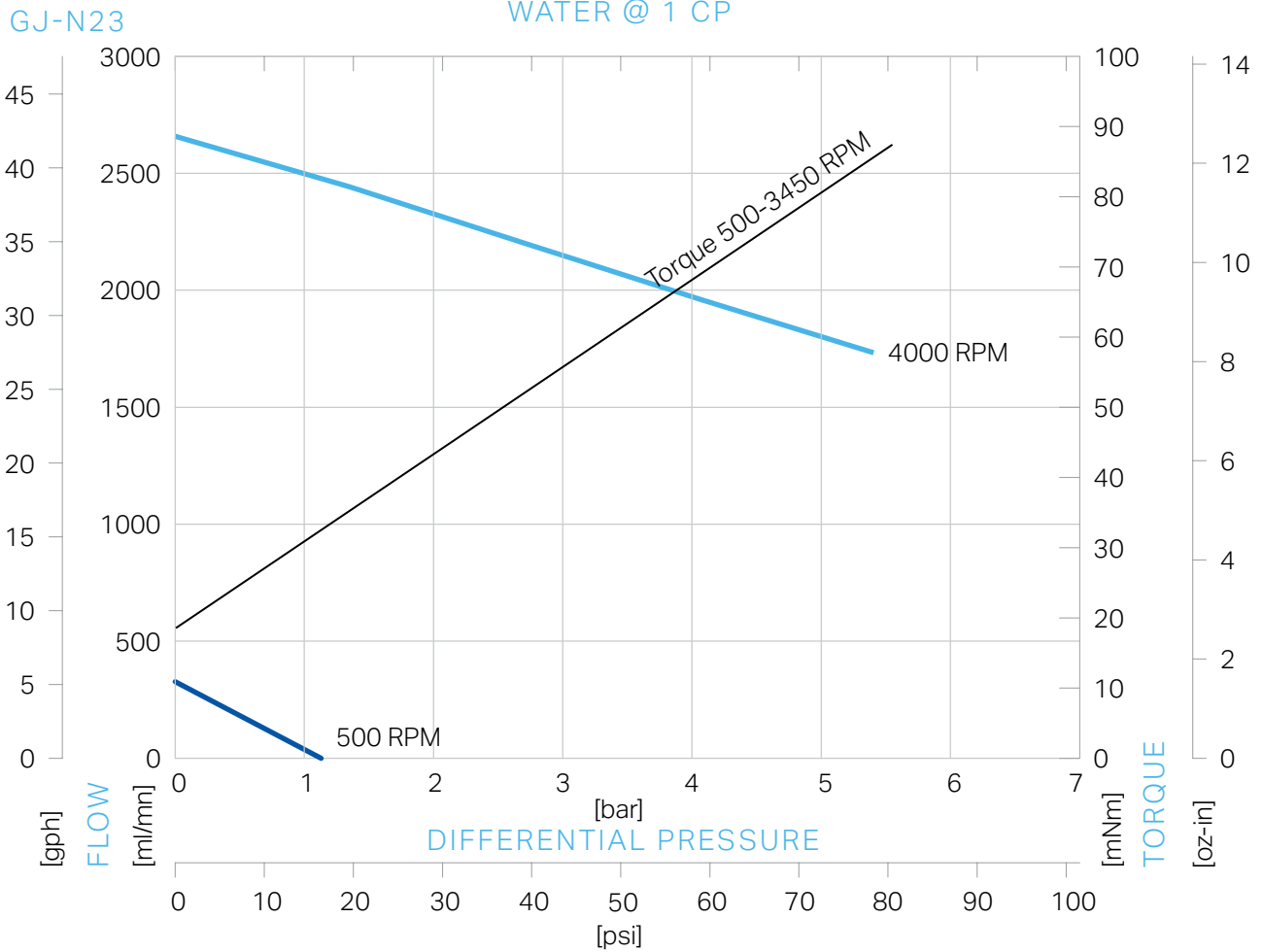

ACTUAL PERFORMANCE MAY VARY - Specifications are subject to change without notice. When multiple specs are noted, the most conservative value applies.

Technical Specification Data

| Order Code | | | | | | | | Pump Construction | |
|------------|----|----------|-----|------------------|---|---|---|----------------------------------|--|
| Base Code | | Gear Set | | Drive Mount | | | | Magnetic Drive Gear Pump | |
| G | JR | - | N23 | | | | | Cavity Style | |
| 1 | 2 | 3 | 4 | 5 | 6 | 7 | 8 | Two Spur, Shafted Gears | |
| Model | | | | Wetted Materials | | | | Sleeve Bushings/Gasket Seals (2) | |
| | | | | | | | | PTFE Bevel or O-Ring Seal (1) | |
| | | | | | | | | O/C: Pump S/K: Service Kit | |

Performance-High Viscosity

GJ-N23

OIL @ 100 CP

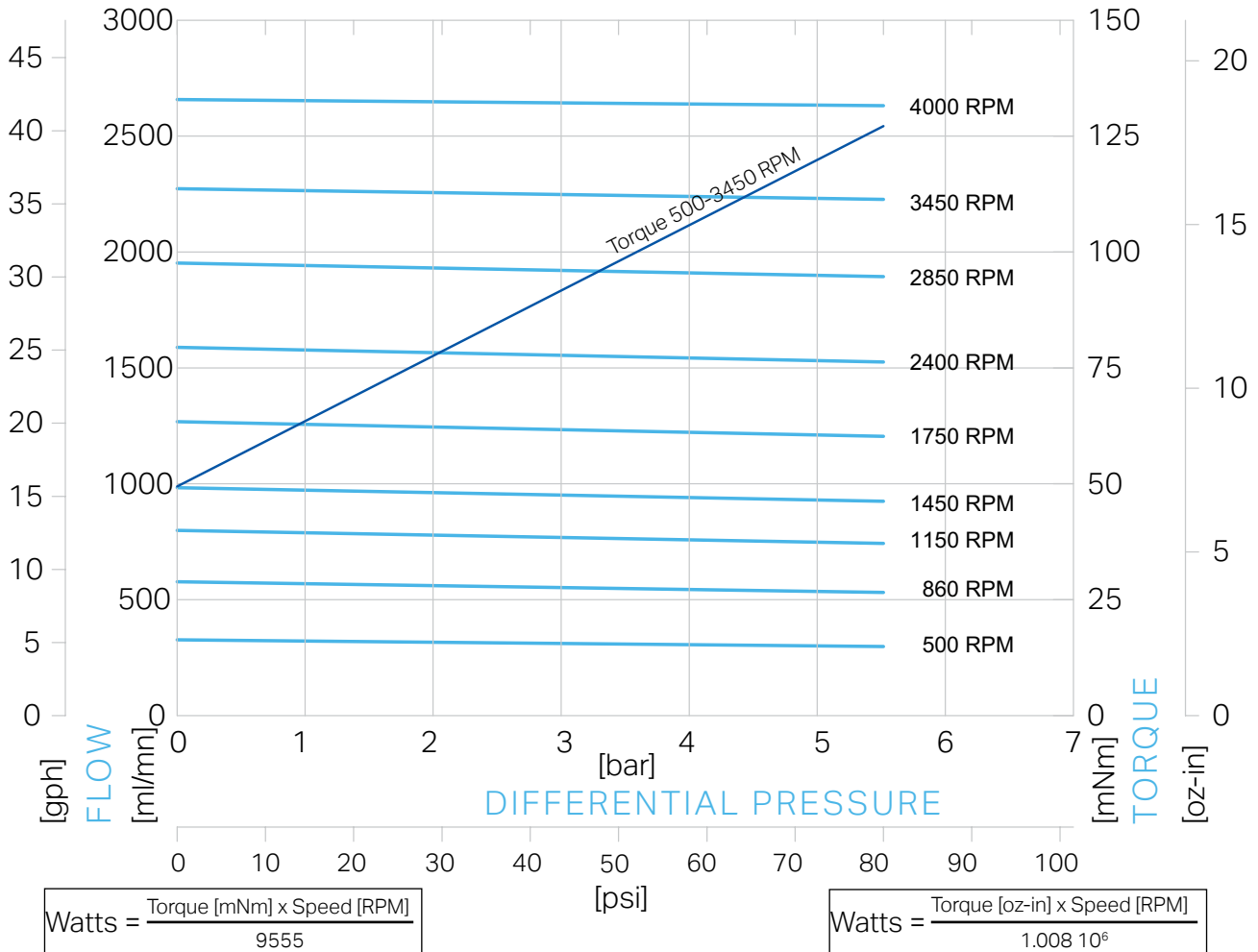

To calculate torque, multiply correction factor by torque from viscosity curve above.

| Torque Correction Factors: For Higher Viscosity Liquids | | | | |
|---|-------|--------|------|------|
| Viscosity [cp] | | 1 | 100 | 1500 |
| Max Speed [RPM] | | 10,000 | 3450 | 860 |
| [Bar] | [psi] | | | |
| 0.3 | 5 | 0.2 | 1 | 2.3 |
| 1.4 | 20 | 0.3 | 1 | 2.1 |
| 2.8 | 40 | 0.4 | 1 | 1.9 |
| 4.1 | 60 | 0.5 | 1 | 1.8 |
| 5.5 | 80 | 0.5 | 1 | 1.6 |

| Magnet Decouple Torque | | | |
|------------------------|-------------|--------------|------------------|
| Driven Magnet | Driving Hub | Torque [mNm] | Torque [oz. in.] |
| Ferrite | Ferrite | 113 | 16 |
| Ferrite | Ferrite | 134 | 19 |
| Ferrite | SmCo | 254 | 36 |
| SmCo | SmCo | 636 | 90 |
| Ferrite | NdFeB | 304 | 43 |
| SmCo | NdFeB | 932 | 132 |

ACTUAL PERFORMANCE MAY VARY - Specifications are subject to change without notice. When multiple specs are noted, the most conservative value applies.

Technical Specification Data

| | | | | | | | | | | | | | | | | | | | | | | | | | |
|---|----|----|-----|------------------|---|---|---|--|---|---|---|---|---|---|---|---|-------|--|--|--|------------------|--|--|--|---|
| <p>Order Code</p> <p>Base Code Gear Set Drive Mount</p> <table border="1" style="width: 100%; text-align: center;"> <tr> <td style="width: 12.5%;">G</td> <td style="width: 12.5%;">JR</td> <td style="width: 12.5%;">-</td> <td style="width: 12.5%;">N23</td> <td style="width: 12.5%;"></td> <td style="width: 12.5%;"></td> <td style="width: 12.5%;"></td> <td style="width: 12.5%;"></td> </tr> <tr> <td>1</td> <td>2</td> <td>3</td> <td>4</td> <td>5</td> <td>6</td> <td>7</td> <td>8</td> </tr> <tr> <td colspan="4">Model</td> <td colspan="4">Wetted Materials</td> </tr> </table> <p style="text-align: right; font-size: small;">O/C: Pump S/K: Service Kit</p> | G | JR | - | N23 | | | | | 1 | 2 | 3 | 4 | 5 | 6 | 7 | 8 | Model | | | | Wetted Materials | | | | <p>Pump Construction</p> <p>Magnetic Drive Gear Pump Cavity Style Two Spur, Shafted Gears Sleeve Bushings/Gasket Seals (2) PTFE Bevel or O-Ring Seal (1)</p> |
| G | JR | - | N23 | | | | | | | | | | | | | | | | | | | | | | |
| 1 | 2 | 3 | 4 | 5 | 6 | 7 | 8 | | | | | | | | | | | | | | | | | | |
| Model | | | | Wetted Materials | | | | | | | | | | | | | | | | | | | | | |

Specifications

| | SI | US |
|-------------------------------|----------------------------|----------------------------|
| Displacement | 0.64 ml/rev | 0.17 gal/1000*rev |
| Max Flow (4 Pole Speed) | 930 ml/mn 1450 RPM (50Hz) | 18 gal/hr 1750 RPM (60Hz) |
| Max Flow (2 Pole Speed) | 1830 ml/mn 2850 RPM (50Hz) | 36 gal/hr 3450 RPM (60Hz) |
| Max Differential Pressure | 5.5 Bar | 80 psi |
| Max System Pressure (MAWP) | 21 Bar | 300 psi |
| NIPR (Absolute) | 180 mBar | 2.5 psia |
| Wet Lift (Typical) | 2 51 cm.H2O (1450 RPM) | 24 in.H2O (1750 RPM) |
| Temp Range | 3 See Gear Material | See Gear Material |
| Viscosity Range | 4 0.2 to 1500 cp | 0.2 to 1500 cp |
| Max Speed | 5,500 RPM | 5,500 RPM |
| Rotation (Facing Motor Shelf) | CW | CW |
| Weight (Pumphead) | 0.45 kg | 1.0 lbs |
| Dimensions (LxWxH) | See Drawing | See Drawing |
| Ports | 1/8-28 B.S.P.P. Side Ports | 1/8-28 B.S.P.P. Side Ports |
| Driven Magnet (Standard) | Ferrite | Ferrite |

Notes

- 2 - Priming ability varies with operating conditions.
- 3 - See Product Options for specific temp limits.
- 4 - See Performance-High Viscosity for viscosity limits.

Technical Specification Data

| Order Code | | | | | | | | Pump Construction | |
|------------|----|----------|------------------|-------------|---|-------------------------------|---|----------------------------------|--|
| Base Code | | Gear Set | | Drive Mount | | | | Magnetic Drive Gear Pump | |
| G | JR | - | N27 | | | | | Cavity Style | |
| 1 | 2 | 3 | 4 | 5 | 6 | 7 | 8 | Two Spur, Shafted Gears | |
| Model | | | Wetted Materials | | | O/C: Pump S/K: Service Kit | | Sleeve Bushings/Gasket Seals (2) | |
| | | | | | | | | PTFE Bevel or O-Ring Seal (1) | |

Performance

GJ-N27

WATER @ 1 CP

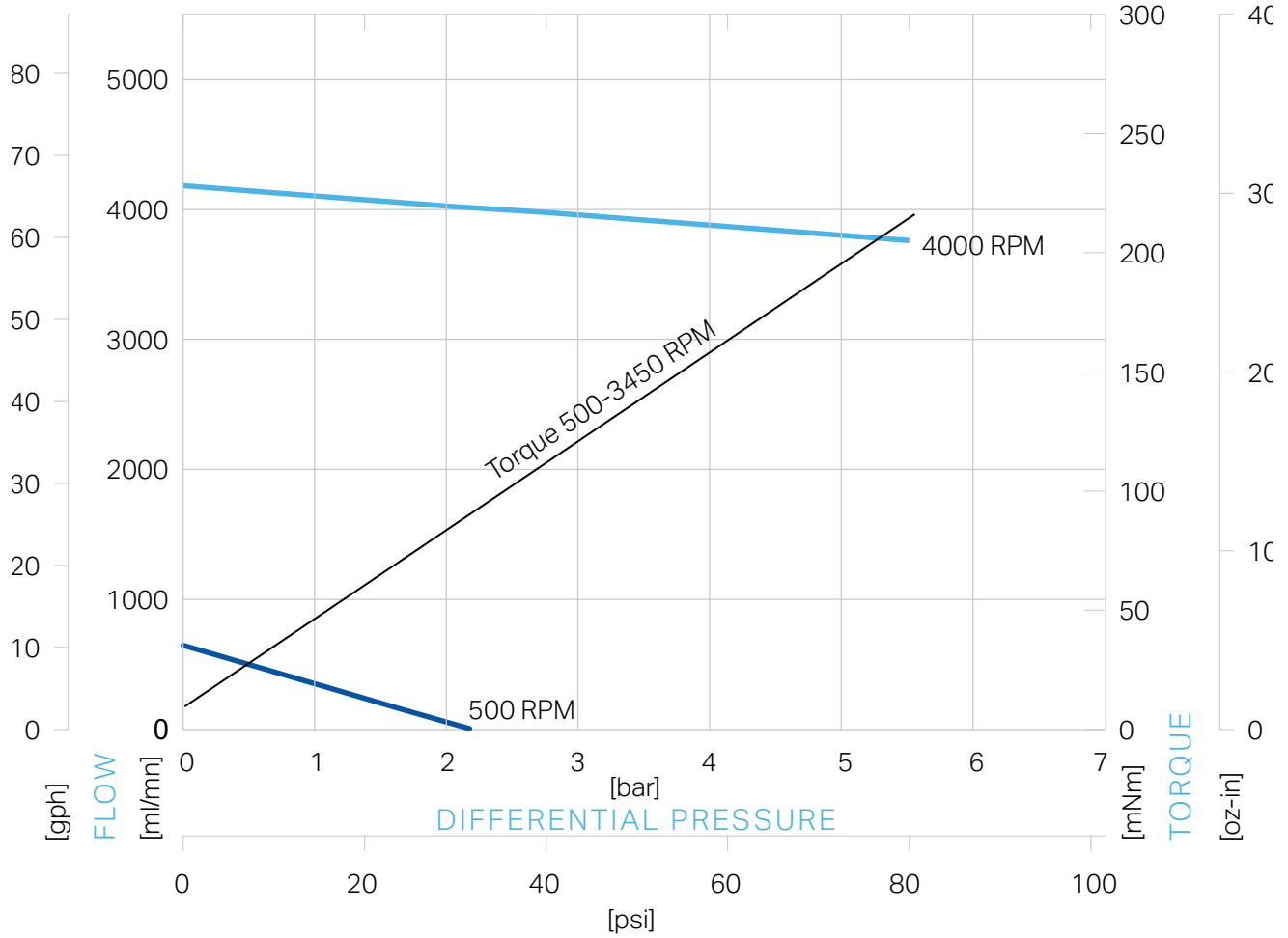

ACTUAL PERFORMANCE MAY VARY - Specifications are subject to change without notice. When multiple specs are noted, the most conservative value applies.

Technical Specification Data

| | | | | | | | | | |
|-------------------|----|----------|------------------|-------------|---|---|-----------|-------------------------------|----------------------------------|
| Order Code | | | | | | | | Pump Construction | |
| Base Code | | Gear Set | | Drive Mount | | | | Magnetic Drive Gear Pump | |
| G | JR | - | N27 | | | | | Cavity Style | |
| 1 | 2 | 3 | 4 | 5 | 6 | 7 | 8 | Two Spur, Shafted Gears | |
| Model | | | Wetted Materials | | | | O/C: Pump | | Sleeve Bushings/Gasket Seals (2) |
| | | | | | | | | PTFE Bevel or O-Ring Seal (1) | |
| | | | | | | | | S/K: Service Kit | |

Performance-High Viscosity

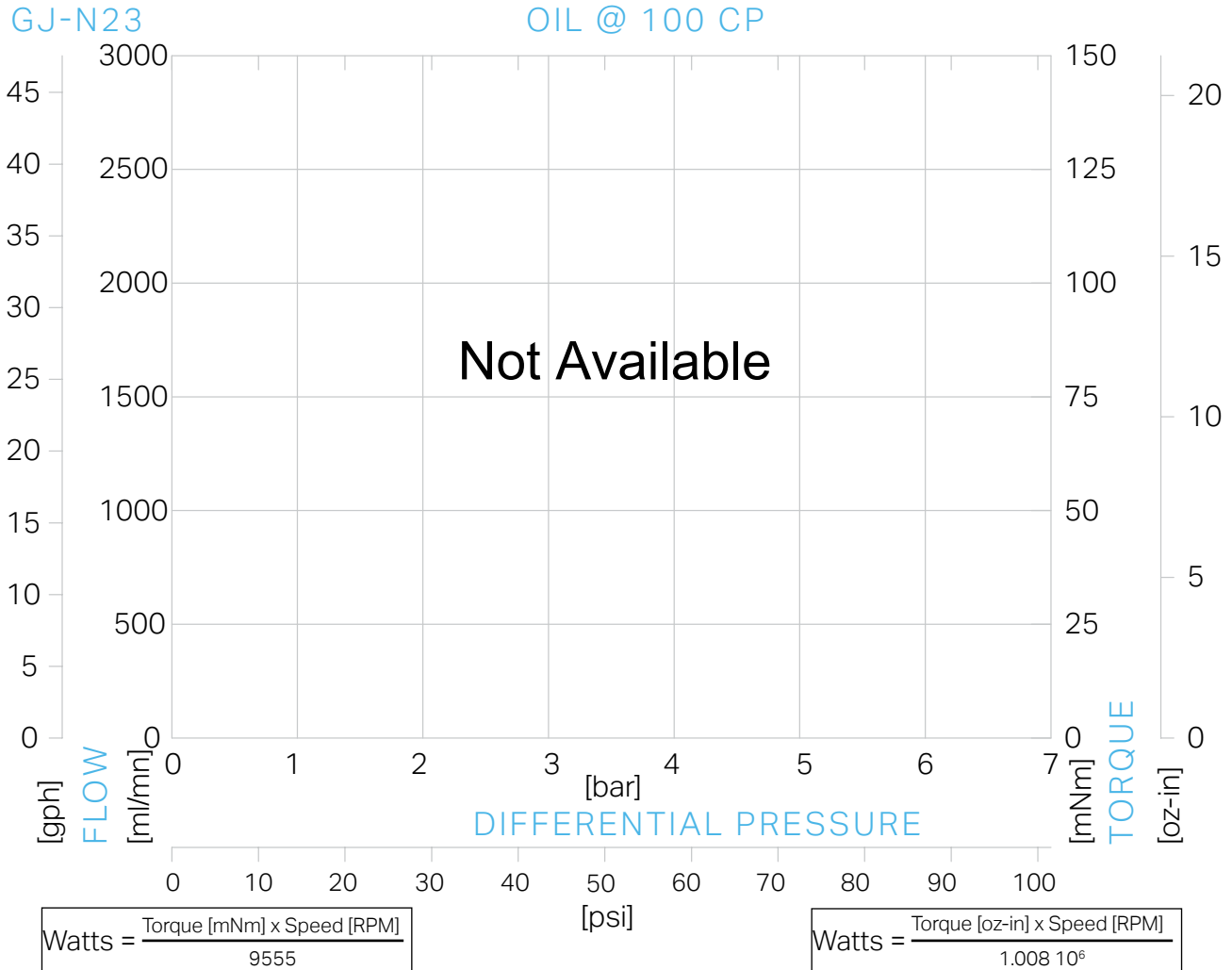

To calculate torque, multiply correction factor by torque from viscosity curve above.

| Torque Correction Factors: For Higher Viscosity Liquids | | | | |
|---|-------|--------|------|------|
| Viscosity [cp] | | 1 | 100 | 1500 |
| Max Speed [RPM] | | 10,000 | 3450 | 860 |
| [Bar] | [psi] | | | |
| 0.3 | 5 | 0.2 | 1 | 2.3 |
| 1.4 | 20 | 0.3 | 1 | 2.1 |
| 2.8 | 40 | 0.4 | 1 | 1.9 |
| 4.1 | 60 | 0.5 | 1 | 1.8 |
| 5.5 | 80 | 0.5 | 1 | 1.6 |

| Magnet Decouple Torque | | | |
|------------------------|-------------|--------------|------------------|
| Driven Magnet | Driving Hub | Torque [mNm] | Torque [oz. in.] |
| Ferrite | Ferrite | 113 | 16 |
| Ferrite | Ferrite | 134 | 19 |
| Ferrite | SmCo | 254 | 36 |
| SmCo | SmCo | 636 | 90 |
| Ferrite | NdFeB | 304 | 43 |
| SmCo | NdFeB | 932 | 132 |

ACTUAL PERFORMANCE MAY VARY - Specifications are subject to change without notice. When multiple specs are noted, the most conservative value applies.

Technical Specification Data

| Order Code | Pump Construction | | | | | | | | | | | | | | | | | | | | | | | | | | | |
|--|-------------------|----|------------------|-----|---|-------------|---|-------------------------------|--|---|---|---|---|---|---|---|---|--|-------|--|--|------------------|--|--|-------------|--|-------------------------------|---|
| <p>Base Code</p> <table border="1"> <tr> <td>G</td> <td>JR</td> <td>-</td> <td>N27</td> <td></td> <td></td> <td></td> <td></td> <td></td> </tr> <tr> <td>1</td> <td>2</td> <td>3</td> <td>4</td> <td>5</td> <td>6</td> <td>7</td> <td>8</td> <td></td> </tr> <tr> <td colspan="3">Model</td> <td colspan="3">Wetted Materials</td> <td colspan="2">Drive Mount</td> <td>O/C: Pump S/K: Service Kit</td> </tr> </table> | G | JR | - | N27 | | | | | | 1 | 2 | 3 | 4 | 5 | 6 | 7 | 8 | | Model | | | Wetted Materials | | | Drive Mount | | O/C: Pump S/K: Service Kit | <p>Magnetic Drive Gear Pump Cavity Style Two Spur, Shafted Gears Sleeve Bushings/Gasket Seals (2) PTFE Bevel or O-Ring Seal (1)</p> |
| G | JR | - | N27 | | | | | | | | | | | | | | | | | | | | | | | | | |
| 1 | 2 | 3 | 4 | 5 | 6 | 7 | 8 | | | | | | | | | | | | | | | | | | | | | |
| Model | | | Wetted Materials | | | Drive Mount | | O/C: Pump S/K: Service Kit | | | | | | | | | | | | | | | | | | | | |

Specifications

| | SI | US |
|-------------------------------|-----------------------------------|-----------------------------------|
| Displacement | 1.23 ml/rev | 0.32 gal/1000*rev |
| Max Flow (4 Pole Speed) | 1630 ml/mn 1450 RPM (50Hz) | 32 gal/hr 1750 RPM (60Hz) |
| Max Flow (2 Pole Speed) | 3250 ml/mn 2850 RPM (50Hz) | 1.0 gal/mn 3450 RPM (60Hz) |
| Max Differential Pressure | 5.5 Bar | 80 psi |
| Max System Pressure (MAWP) | 21 Bar | 300 psi |
| NIPR (Absolute) | 180 mBar | 2.5 psia |
| Wet Lift (Typical) | 51 cm.H ₂ O (1450 RPM) | 24 in.H ₂ O (1750 RPM) |
| Temp Range | See Gear Material | See Gear Material |
| Viscosity Range | 4 0.2 to 1500 cp | 0.2 to 1500 cp |
| Max Speed | 5,500 RPM | 5,500 RPM |
| Rotation (Facing Motor Shelf) | CW | CW |
| Weight (Pumphead) | 0.45 kg | 1.0 lbs |
| Dimensions (LxWxH) | See Drawing | See Drawing |
| Ports | 1/8-28 B.S.P.P. Side Ports | 1/8-28 B.S.P.P. Side Ports |
| Driven Magnet (Standard) | Ferrite | Ferrite |

Notes

4 - See Performance-High Viscosity for viscosity limits.

Technical Specification Data

| Order Code | | | | | | | | Pump Construction | | |
|------------|----|----------|---|---|------------------|---|-------------------------------|-------------------------------|----------------------------------|--|
| Base Code | | Gear Set | | | Drive Mount | | | Magnetic Drive Gear Pump | | |
| G | JR | | | | | | | Cavity Style | | |
| 1 | 2 | 3 | 4 | 5 | 6 | 7 | 8 | Two Spur, Shafted Gears | | |
| Model | | | | | Wetted Materials | | O/C: Pump S/K: Service Kit | | Sleeve Bushings/Gasket Seals (2) | |
| | | | | | | | | PTFE Bevel or O-Ring Seal (1) | | |

Dimensions

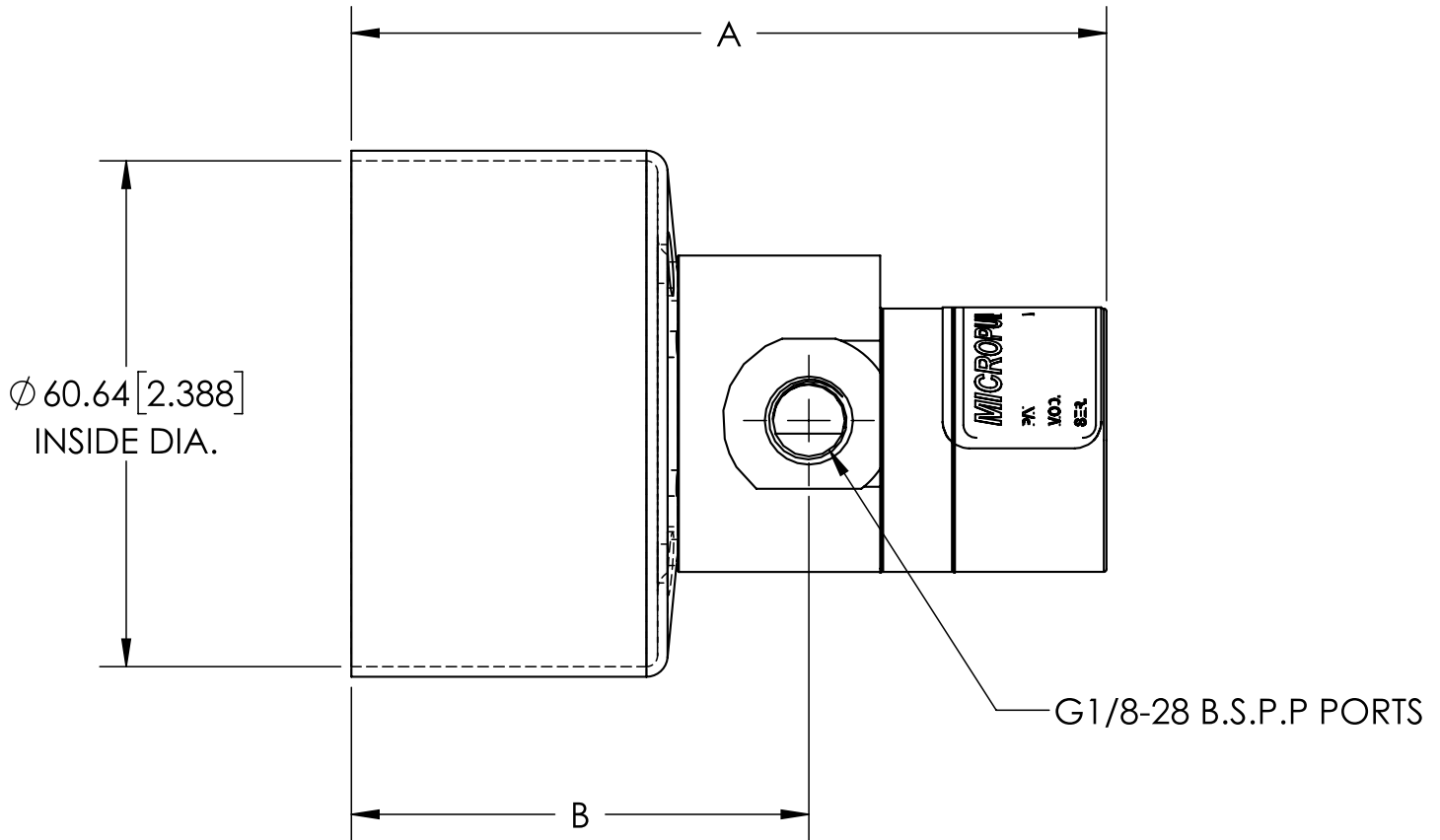

| GEAR SET | A (MAX) mm [in] | B mm [in] |
|----------|--------------------|--------------|
| N21 | 86.11 [3.39] | 54.83 [2.16] |
| N23 | 90.50 [3.56] | 54.83 [2.16] |
| N23 | 99.27 [3.91] | 54.83 [2.16] |

Technical Specification Data

| Order Code | | | | | | | | Pump Construction |
|------------|----|----------|---|------------------|-------------|---|-------------------------------|----------------------------------|
| Base Code | | Gear Set | | | Drive Mount | | | Magnetic Drive Gear Pump |
| G | JR | | | | | | | Cavity Style |
| 1 | 2 | 3 | 4 | 5 | 6 | 7 | 8 | Two Spur, Shafted Gears |
| Model | | | | Wetted Materials | | | O/C: Pump S/K: Service Kit | Sleeve Bushings/Gasket Seals (2) |
| | | | | | | | | PTFE Bevel or O-Ring Seal (1) |

NEMA Mount Dimensions

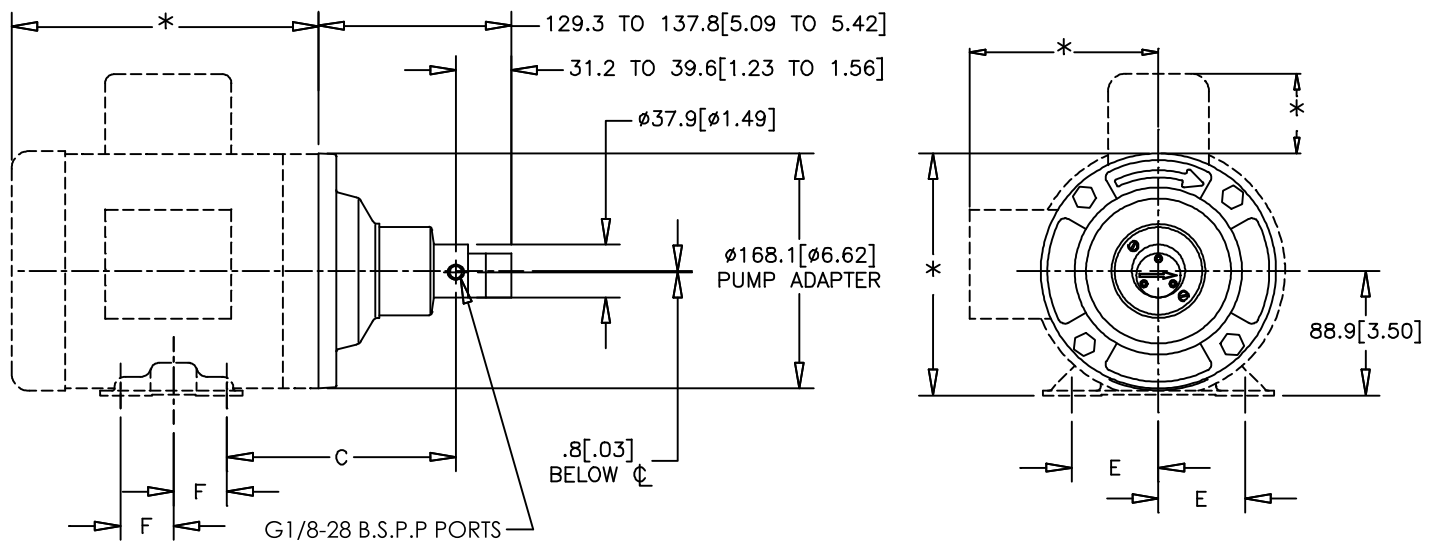

| MOUNT | C mm [in] | E mm [in] | F mm [in] |
|-------------------------|--------------|--------------|--------------|
| NEMA ^E 56C | 163.4 [6.43] | 61.9 [2.44] | 38.1 [1.50] |
| NEMA ^K 143TC | 158.5 [6.24] | 69.9 [2.75] | 50.8 [2.00] |
| NEMA ^K 145TC | 158.5 [6.24] | 69.9 [2.75] | 63.5 [2.50] |

NOTES:

- *THESE DIMENSIONS WILL VARY BASED ON MOTOR SELECTION.
- ALL DIMENSIONS ARE NOMINAL.

Technical Specification Data

| Order Code | | | | | | | | Pump Construction | |
|------------|----|----------|------------------|-------------|---|-------------------------------|---|----------------------------------|--|
| Base Code | | Gear Set | | Drive Mount | | | | Magnetic Drive Gear Pump | |
| G | JR | | | | | | | Cavity Style | |
| 1 | 2 | 3 | 4 | 5 | 6 | 7 | 8 | Two Spur, Shafted Gears | |
| Model | | | Wetted Materials | | | O/C: Pump S/K: Service Kit | | Sleeve Bushings/Gasket Seals (2) | |
| | | | | | | | | PTFE Bevel or O-Ring Seal (1) | |

IEC 56 Mount Dimensions

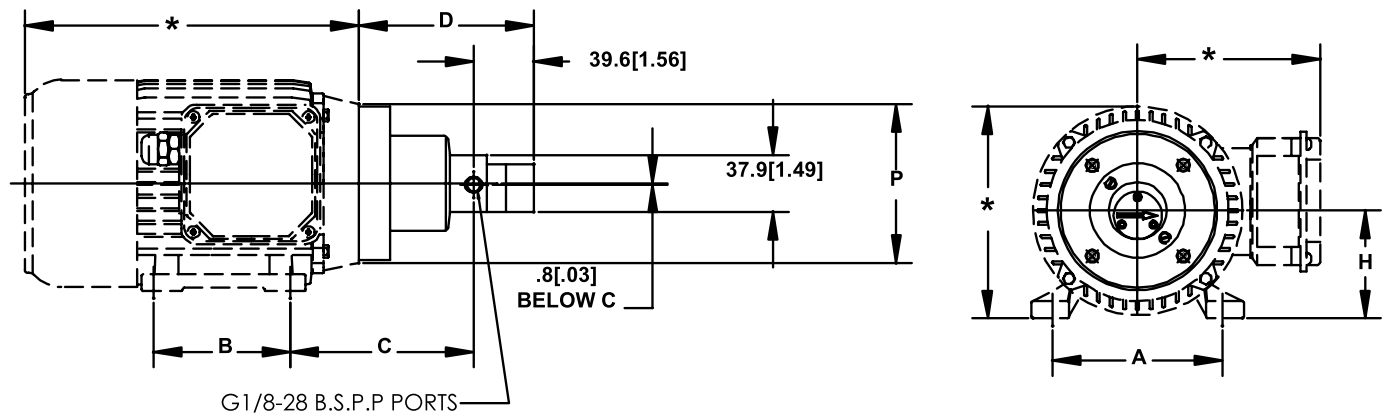

| MOUNT | A mm [in] | B mm [in] | C mm [in] | D mm [in] | H mm [in] | P mm [in] |
|-----------------|--------------|--------------|--------------|------------------------------|--------------|--------------|
| 2 IEC56B14B3 | 90 [3.54] | 71 [2.80] | 99.2 [3.90] | 94.5 [3.72] TO 102.8 [4.05] | 56 [2.20] | 80 [3.15] |
| 4 IEC63B14B3 | 100 [3.94] | 80 [3.15] | 108.8 [4.28] | 100.1 [3.94] TO 108.5 [4.27] | 63 [2.48] | 90 [3.54] |
| 6 IEC71B14B3 | 112 [4.41] | 90 [3.54] | 120.8 [4.76] | 107.1 [4.22] TO 115.5 [4.55] | 71 [2.80] | 105 [4.13] |

NOTES:

- *THESE DIMENSIONS WILL VARY BASED ON MOTOR SELECTION.
- ALL DIMENSIONS ARE NOMINAL.

AUSTRALIAN DISTRIBUTOR



CALL 1300 789 466
 When Pump Knowledge Matters
www.kelairpumps.com.au